



Public Address Speaker

*Two-way High Fidelity Waterproof Horn Speaker
H-168HD*



OWNER'S MANUAL

Thank you for purchasing our PA speaker. All of products have been tested strictly before shipping. Our speaker system is widely used in hotel, building, train station, supermarket, school, entertainment, etc. It's the most ideal choice of you! In order to facilitate installing, modulating and running, please read this manual carefully before setup.

FEATURES:

- Two-way speaker, very clear, sweet sound, high sensitivity.
- Waterproof, made with high quality alloy-aluminum grille and high durable engineering plastic material.
- Streamline appearance, beautiful design.

FREQ. RESPONSE

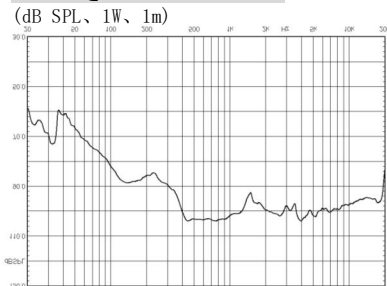

DISTORTION

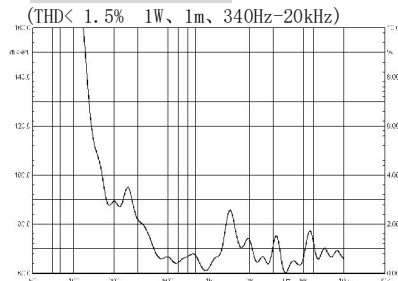

INSTALLATION

- 1、 Fit 4 M6 screws on the mounting surface and fixup the wall fixing slab (Figure①);
- 2、 Connect the speaker to the bracket (Figure ②);

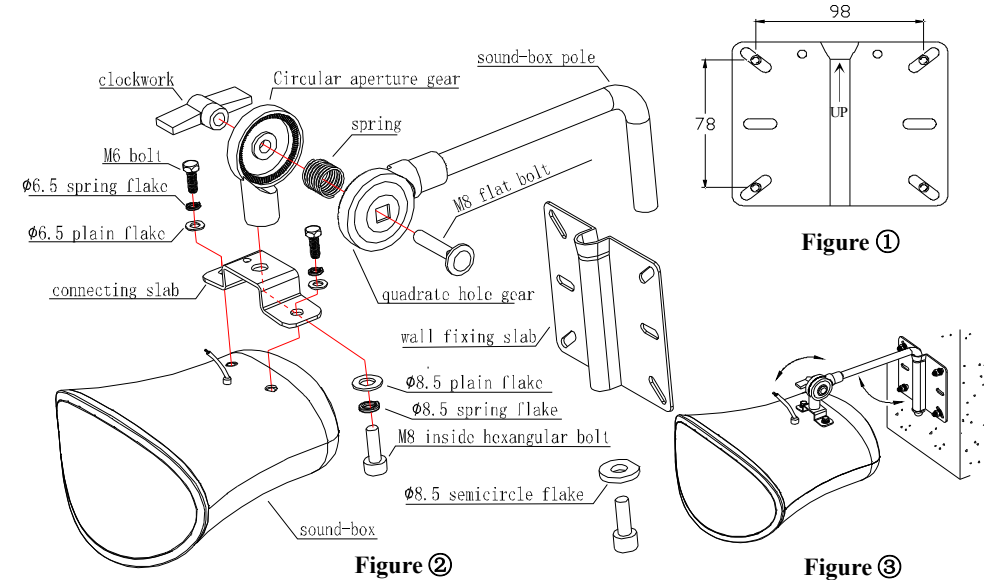

- 3、 Insert the sound-box pole into the wall fixing slab and fix up (Figure③) ;
- 4、 Rotate the bracket to adjust the speaker angle, check and ensure whether it is steady .

SPECIFICATIONS

Frequency Response	340 Hz-20, 000 Hz
Sensitivity (1m, 1W)	103±2 dB
Max. SPL	120±2 dB
Input Voltage	100V
Rated Power	50W
Dimension(L×D×H)	393 mm×403 mm×267 mm
Weight	6.1 kg (13.6 lbs)